

DRAFT

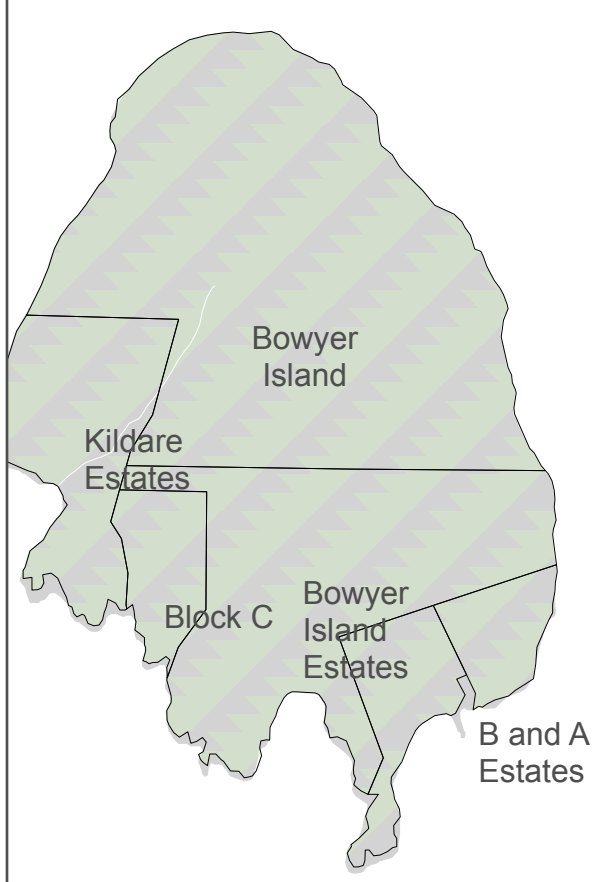

— Highway
 — Electoral Area A Boundary
 — BC Pk, Ecological Reserve, or Protected Area
 — Regional Park
Land Use
 ■ Small Lot Rural
 ■ Large Lot Rural
 ■ Low Density Residential
 ■ Medium Density Residential
 ■ Parks
 ■ Resource
 ■ Watershed
 ■ Transportation

0 0.5 1 1.5
Kilometres

1161105445-task3-007 REVA NAD 1983 UTM Zone 10N

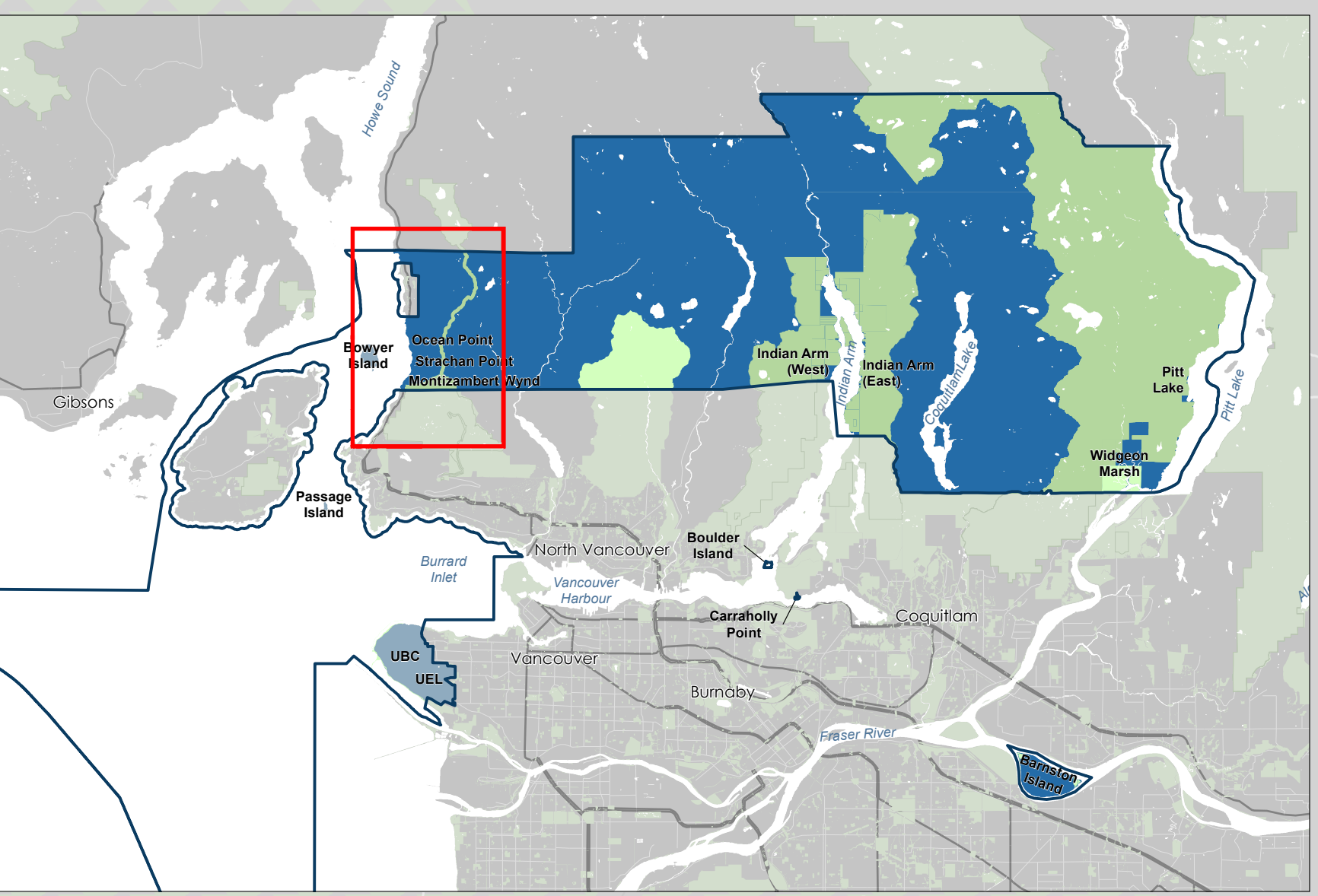
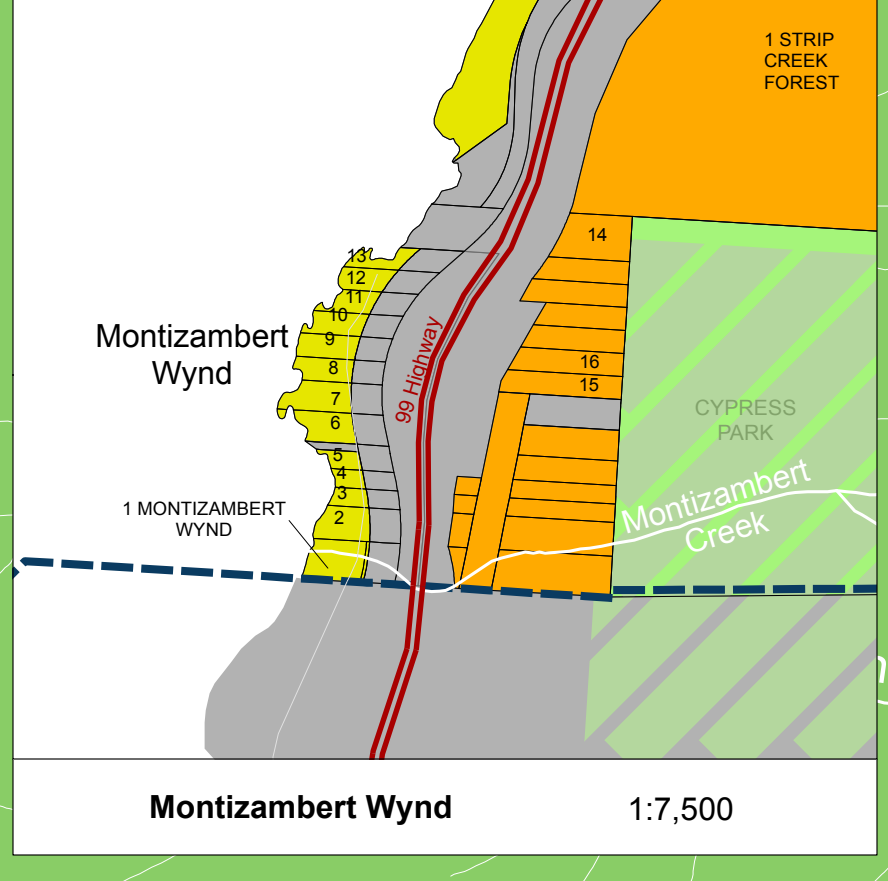
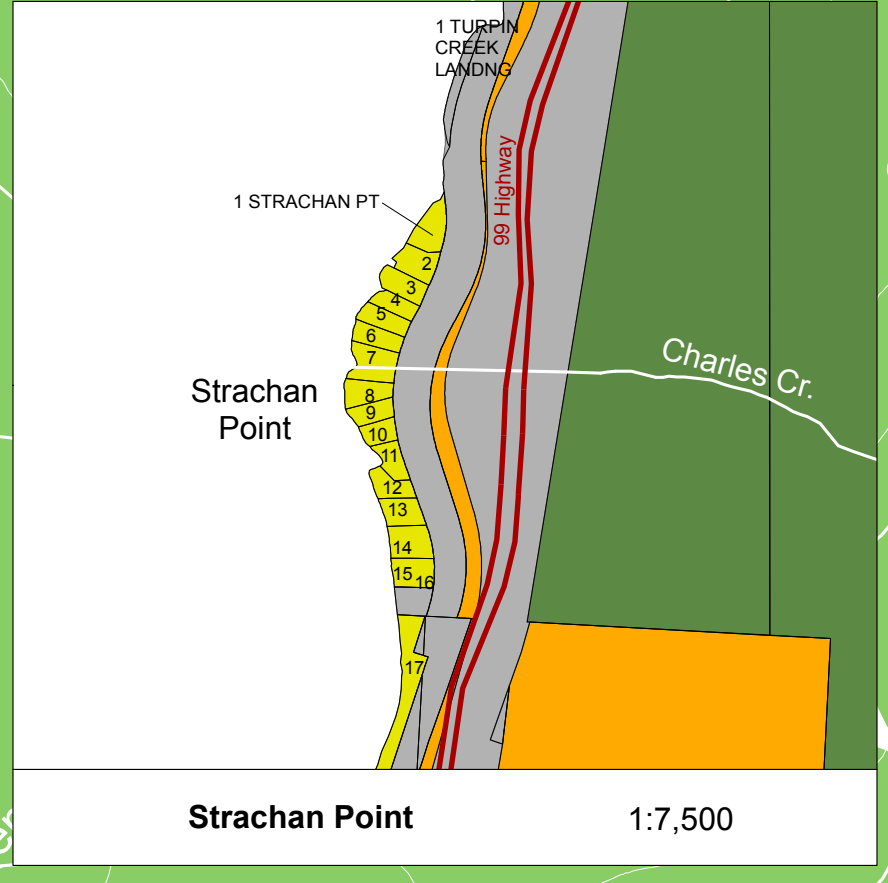
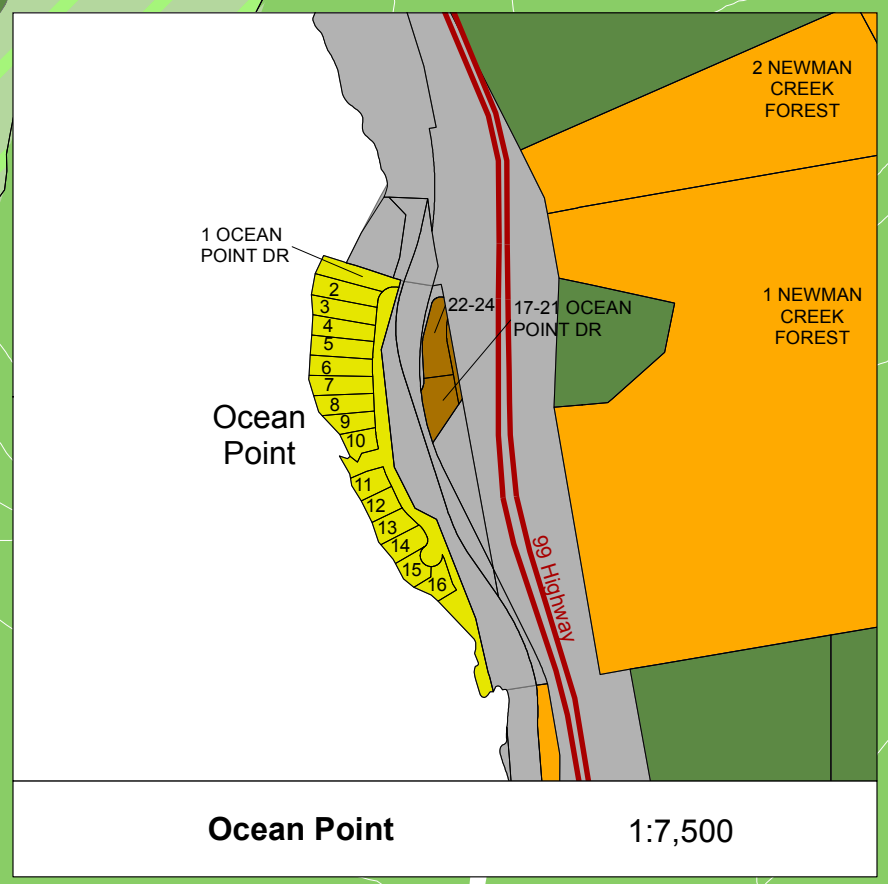
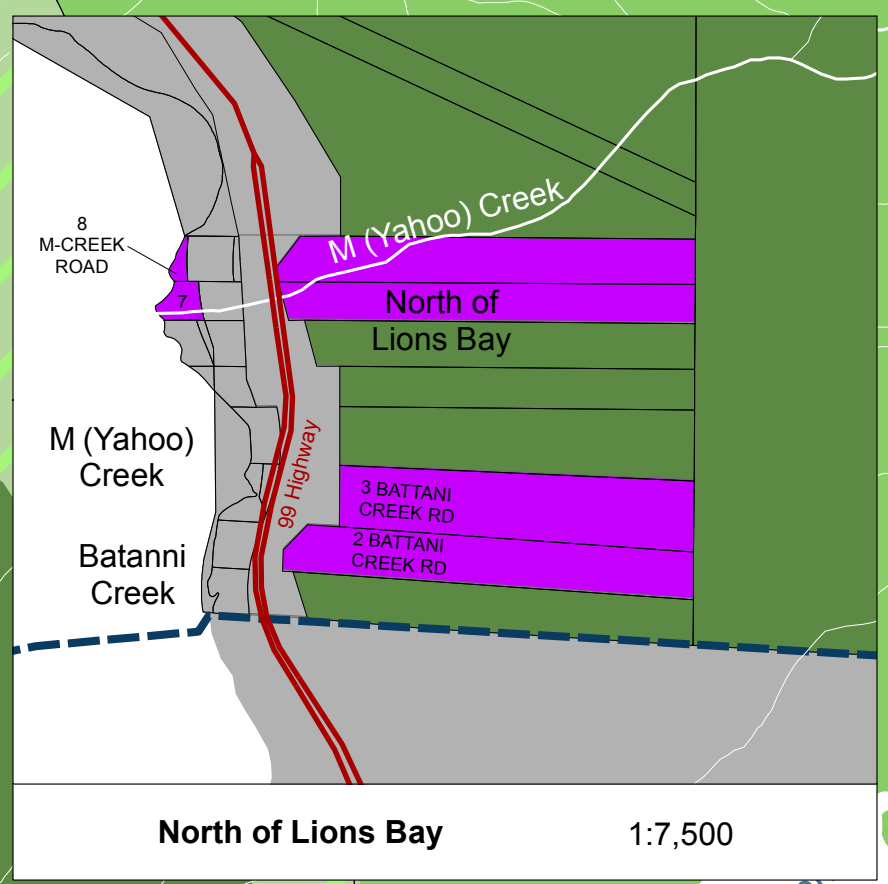

These 8 large orange parcels

These 2 large orange parcels

Sources: metrovancouver, CanVec, GeoBC

Disclaimer: This map is for illustrative purposes to support this Stantec project; questions can be directed to the issuing agency.



DRAFT

**Ocean Point; Strachan Point; Montizambert Wynd;
Lots North of Lions Bay; M-Creek and Battani Creek
Land Use**

**Electoral Area A
Official Community Plan**

